



MECAROANNE

— Solutions de broyage —

Toothed roll crusher TYPE R 200, R 240, R 300

FIELD OF APPLICATION

- › **Humid, soft, clogging products** such as clays, kaolin, chalk, lime, clay soils, marls, unfired tiles and bricks, mud...
- › **Hard products** (recycling or volume reduction) such as fibre cement boards, slates, plaster (mouldings, boards, tiles), stoneware or vitreous sanitary fittings, cellular concrete, fired bricks and tiles, talc, glass, clinker, coke, coal, batteries...
- › **All products which are agglomerated** by nature during production and/or due to a high moisture content (fertilizer, sodium chloride in the form of blocks, chemical products in general)...



OPERATING PRINCIPLE

Two rotors turning in opposite directions at slow and differential speed, are fitted with disks and blades designed to shred the product : they are constantly cleaned by scrapers which can be individually adjusted.



www.mecaroanne.com



TECHNICAL CHARACTERISTICS

Type	∅ rotors	A	B	C	D	E	F	G	H	Weight	Output particle size*	Installed power	Capacity*
	mm	mm	mm	mm	mm	mm	mm	mm	mm	kg	mm	kW	T/hour
R 200x400	200	400	660	400	650	1160	920	720	1020	900	0 to 20	7.5	4
R 200x600	200	600	660	600	650	1360	920	720	1020	1100	0 to 20	9	8
R 200x800	200	800	660	800	650	1580	920	720	1020	1300	0 to 20	11	10
R 240x600	240	600	760	600	730	1525	990	720	---	1600	0 to 30	15	12
R 240x800	240	800	760	800	730	1725	990	720	---	1900	0 to 30	18.5	15
R 300x800	300	800	1000	800	1000	1850	1410	1000	---	3600	0 to 40	22	20
R 300x1000	300	1000	1000	1000	1000	2050	1410	1000	---	3950	0 to 40	22	30
R 300x1200	300	1200	1000	1200	1000	2250	1410	1000	---	4300	0 to 40	30	40

* mean values for a product of density 1.5, varying according to the type of materials treated and the configuration of the grinding shafts (fine, normal or large particle size).

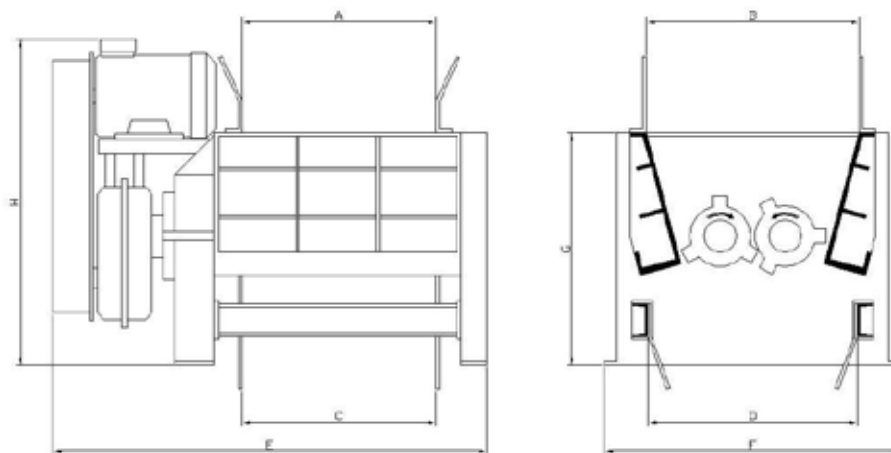

DESIGN

Our devices have a very **thick rigid frame** made of welded sheet metal (stainless steel on option). The reduction and transmission mechanisms (housed in a sealed oil sump) are grouped on the same side of the device. This layout allows the grinding tools **to be replaced quickly** without having to completely dismantle the device. Moreover, a simple and reliable safety system avoids any mechanical breakage in the event of blockage by a foreign body.

